

T.B. VEGAS TRIO



The package includes : T.B.VEGAS TRIO fan * 1 , Isolator-mounts * 4 , 3 pin to 4 pin adaptor * 1 , Adhesive tape * 1

Installation

1. PC power off at all times during installation
2. Please refer to Figure A for the airflow directions
3. Install the isolator-mounts on the fan and then fasten the isolator-mounts on the case



For fan part For case part

4. Connect the PWM 4 pin connector to a specific PWM or 3 pin 12V header on the motherboard. Or use the enclosed 3 pin to 4 pin adaptor to connect it to a 4 pin Molex from power supply. (PWM-control requires a PWM-enabled motherboard and connection so that you can adjust fan speed via BIOS-motherboard.)



Selecting the LED modes

Click the LED button to select a LED mode

- * Quick Off Function: Press the button for 3 seconds for "OFF" mode
- * Memory Function: The LED mode would remain the mode before restart
- * The switch can be mounted onto the case by using the enclosed adhesive tape



Detaching the fan blades

Carefully push out the fan blades with your thumbs in the inner area



back view

side view

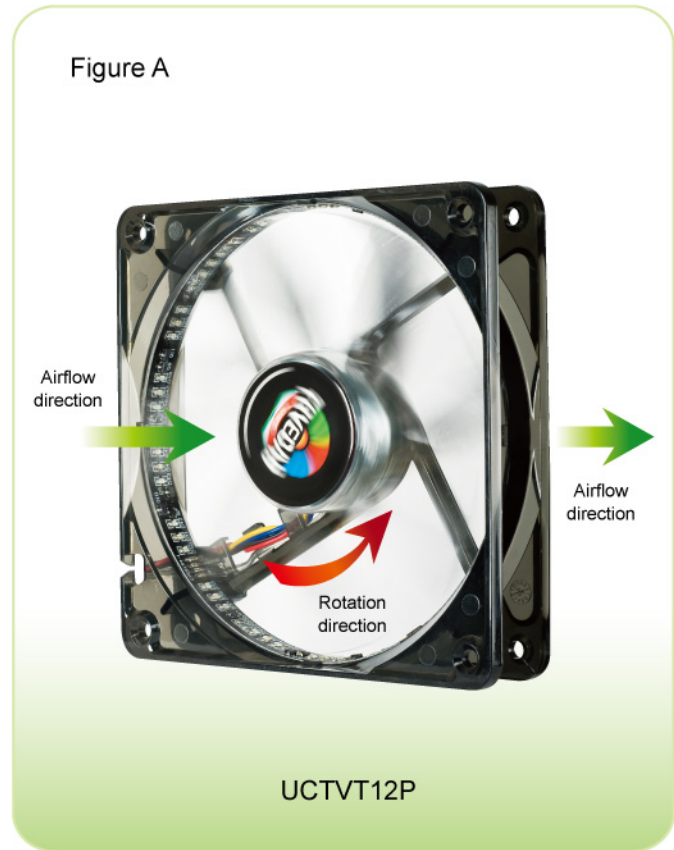

Reattaching the fan blades

Press the center of the blades towards the frame until it clicks

